



# AGRIMA ROOF & FAÇADE SYSTEMS



**KINGSPAN (IRELAND)**  
ALUMINIUM ROOF & FACADE



**PALRAM (ISRAEL)**  
POLYCARBONATE LIGHTINGS



**LYSAGHT (TATA)**  
GALVALUME ROOF & FACADE



We are happy to introduce AGRIMA capabilities and competence in the realm of Project Management of Engineering and Construction. Over a period of three decades, we have demonstrated our expertise in managing the projects on a wide variety of scale from Nuclear Power Projects to Pre-Engineered Buildings. We are a team of interrelated professionals undertaking projects as value creation and change agents. We cover end to end activities on all the facets of project management including theory and practice.

We assure our services with level of confidence and value creation. We request your kind perusal of this small introduction.

A handwritten signature in black ink, appearing to be 'B. Govind Ramesh'.

B. Govind Ramesh  
Chief Mentor  
Team Agrima



SVS Warehouse, Bengaluru



Pokarna Engineered Stone Pvt Ltd.,Hyderabad



Best performance appreciation from  
"Quantra Quartz", Hyderabad

### SYSTEM COMPONENTS

1. PRIMARY FRAME - Primary framing of a PEB is an assembly of built-up I Shaped steel members & that framing consist trusses , castellated beams etc.
2. SECONDARY STRUCTURAL ELEMENTS – Cold Formed Members, which can be in diff. shapes like "Z", "C" etc. In general known as "Purlins".
3. ROOF & WALL PANELS – Generally consists of Roll-formed steel sheets.
4. OTHER ACCESSORIES - Tapping Screws, Bolts, Insulation, etc.

### APPLICATIONS

- Factories, Warehouses, Workshops
- Gas stations
- Showrooms
- Aircraft hangers
- Metro stations
- Vehicle parking sheds
- Schools, Indoor stadium roofs

### WORKS EXECUTED

- Coated Steel Plant, Jamshedpur - Area – 50,000 Sqm
- Flextronics, Chennai - Area –25000 Sqmt
- Amazon Facilitation centre, Bengaluru - Area – 32,000 Sqm
- Sakalavara Warehouse, Bengaluru - Area – 22,000 Sqm
- DHL Warehouse, Bengaluru - Area – 30,000 Sqm
- Pokarna Engineered Stone Pvt Ltd.,Hyderabad-Area- 49000 Sqm
- Bangalore International Airport - Area – 20173 Sqm
- Pre Engineered Warehouse for SS Developers JV3, Bengaluru Area - 12054 Sqm
- Pre Engineered Warehouse for SS Developers JV2, Bengaluru Area - 23468 Sqm
- Pre Engineered Warehouse for Janamukhi Trading Co.,Bengaluru Area - 14016 Sqm
- Pre Engineered Warehouse RKV3,Bengaluru -Area-31462 Sqm
- Pre Engineered Warehouse RKV4, Bengaluru- Area - 21337 Sqm
- Pre Engineered Warehouse RKV5, Bengaluru- Area - 8940 Sqm
- Master Insert Plant Expansion for Kennametal India Pvt Ltd, Bengaluru – Area – 6138 Sqm and many more works.
- Many more works throughout India

Agrima expertise in pre-engineered buildings runs several decades. Based on the customers' requirement, team Agrima provides innovative and timely solutions. Throughout the construction of the steel structure, the Agrima team adds up for the Quality and intelligent solutions in line with customers' challenging and demanding requirements.

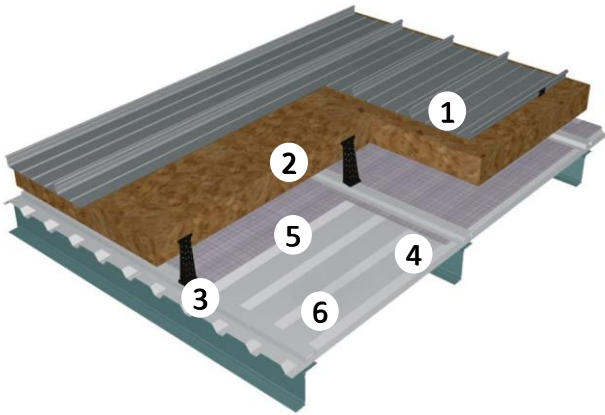

System components



GT Mall, Bengaluru



Nettur Technical Training Foundation, Katpadi

### SYSTEM COMPONENTS

1. Standing Seam profile
2. Insulation
3. ST - Clip
4. Sub hat - Top hat Brackets
5. Vapour control Layer
6. Trapezoidal Liner sheet

### APPLICATIONS

- Suitable for warm and cold roof constructions in all shapes and pitches from 1.5°, catering for all types of supporting structures.
- Can be flexibly adjusted to suit the layout, geometry and dimensions of any building.
- Extremely strong and lightweight.
- Ideal for large spans and renovating old roofs.
- Continuous lengths of 150 metres and more, when production takes place on-site.

### WORKS EXECUTED

- Nettur Technical Training Foundation, Katpadi Area - 1400 Sqm
- Stone hill International School, Bengaluru - Area - 1500 Sqm
- HCL Cafeteria, Noida - Area - 5000 Sqm
- Gopalan Legacy Mall, Bengaluru - Area - 2800 Sqm
- GT World Mall, Bengaluru etc., - Area - 1600 Sqm
- CSI St. John's Church, Pondicherry - Area - 850 Sqm
- CSI Wesley English Church, Chennai - Area - 267 Sqm
- Big Rock Dirt Park, Kolar - Area - 123 Sqm
- Indian Institute of Science Education & Research, Tirupati - Area - 1270 Sqm and many more works.

Note: The above works are of Kalzip as a TeamKal partner, now we have collaborated with Kingspan to expand our product basket.

Agrima works with highly reputed system engineered roofing complementor like KINGSPAN and is known for the quality workmanship and the excellent customer services provided. Team Agrima has the strength to execute system engineered roofing works with utmost innovation resulting in zero-leakage roofs.



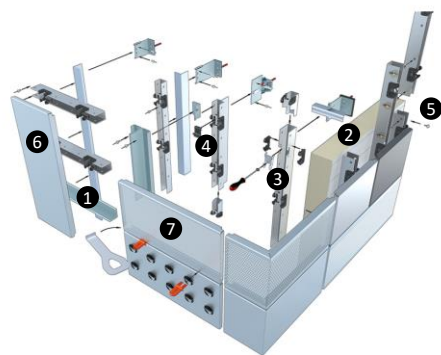

System components



FTO, Dr. Reddy's Laboratory, Pydhi



Merck Millipore Pvt Ltd, Bengaluru

### SYSTEM COMPONENTS

1. Supporting angle
2. Thermal Insulation
3. Fixing point clamp
4. Guidance snapper
5. Fastener
6. FC Façade
7. Perforated Panels

### APPLICATIONS

- Rain screens
- Weather Control System
- Moisture Control
- Solar Control
- Visibility Control

### WORKS EXECUTED

- FTO – 9, Dr. Reddy's Laboratory, Duvvada  
Area – 8200 Sqm
- FTO, Dr. Reddy's Laboratory, Pydhi  
Area – 7000 Sqm
- Potent Block - Dr. Reddy's Laboratory, Pydhi.  
Area – 2000 Sqm
- Hormone Block -Dr. Reddy's Laboratory, Pydhi  
Area – 2000 Sqm
- Merck Millipore Pvt Ltd, Bengaluru  
Area - 700 Sqm

Note: The above works are of Kalzip as a TeamKal partner, now we have collaborated with Kingspan to expand our product basket.

Similar to the Roofing system, Agrima offers a wide range in metal façade system. Being a partner of Kingspan, Agrima works over the metal façade works and is known for the quality workmanship and the excellent customer services provided.

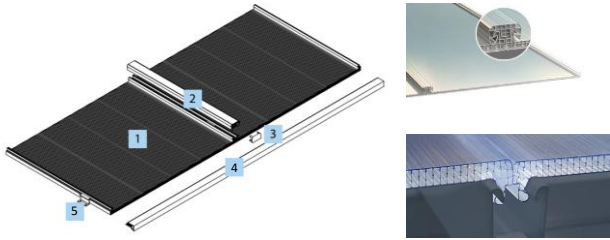

System components



Allahabad International Airport



Nettur Technical Training Foundation, Katpadi

### SYSTEM COMPONENTS

1. Panel
2. PC Joiner
3. End Cap for PC Joiner
4. Aluminium End Cap
5. T-Fastner

### MAIN BENEFITS

- Withstands very high loads
- Accommodates expansion and contraction
- Simple and fast installation
- Leak proof
- High thermal insulation
- Double sided UV protection

### TYPICAL APPLICATIONS:

- Architectural roofing and glazing
- Commercial and retail roofing
- Sport facilities - translucent roofing
- Covered walkways, awnings and entrances
- Open markets - light roofing
- Service stations - translucent roofing
- Parking structure covering
- Swimming pool covers

### WORKS EXECUTED

- Nettur Technical Training Foundation, Katpadi – Area - 500 Sqm
- Palram gallery at Agrima Roof and Façade Systems, Bengaluru - Area - 150 Sqm
- PDS Residency, Krishnagiri - Area - 150 Sqm
- NTTF Learning Café, Bengaluru – Area - 259 Sqm
- Allahabad International Airport – Area - 500 Sqm
- Mr. Subramani's residence, Bengaluru – Area - 95 Sqm
- Oberoi mall, Mumbai – Area - 1830 Sqm
- And many more
- Mr. Joy Residence, Bengaluru – Area - 75 Sqm
- And many more works

Agrima brings out the lighting solutions into the buildings through skylights and poly carbonate roof covers from Palram, Israel. Our strength is our ability to develop innovative, high-quality solutions adapting appropriate products. PALRAM with over 50 years of experience, a large portfolio of products and thousands of customers, is recognized as a leading brand for quality and service.

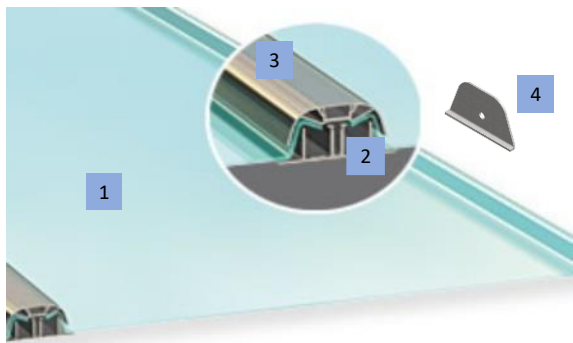

System components



Gokhale Institute of Public Affairs, Bengaluru

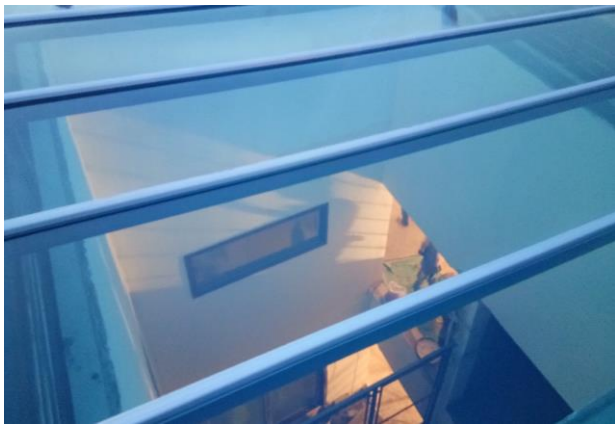

Total Environment Villa, Bengaluru

**SYSTEM COMPONENTS**

1. Poly carbonate Panel
2. Aluminium Base
3. Aluminium Profile Cap
4. Aluminium End Cover

**MAIN BENEFITS:**

- Glass-like clear appearance
- Standing seam leak-proof performance
- Free thermal expansion
- Caulking and silicone free
- Withstands high loads
- Easy, fast and safe installation
- Minimal maintenance

**TYPICAL APPLICATIONS:**

- Architectural projects
- Commercial and retail
- Sports venues roofing
- Covered walkways
- Open markets
- Service stations
- Entrances
- Pool covers

**WORKS EXECUTED:**

- Total Environment project, Bengaluru - Area- 4200 Sqm
- Mr. Subramani's residence, Bengaluru – Area – 95 Sqm
- Gokhale Institute of Public Affairs, , Bengaluru - Area – 282 Sqm

Agrima brings out the lighting solutions into the buildings through skylights and poly carbonate roof covers from Palram, Israel. Our strength is our ability to develop innovative, high quality solutions adapting appropriate products. PALRAM with over 50 years of experience, a large portfolio of products and thousands of customers, is recognized as a leading brand for quality and service.

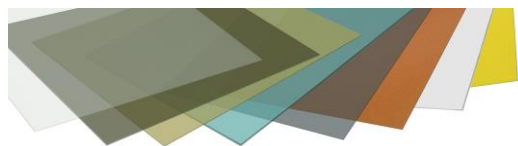

Polycarbonate Sheet



Roof monitor at JV3 Warehouse, Bengaluru



Roof monitor at SVS warehouse, Bengaluru



PDS Residence, Krishnagiri

**PALSUN** combines ultra-high impact resistance with clarity, making it the material of choice for demanding applications.. Clear ,translucent, unbreakable and opaque PALSUN sheets are also ideal as machine guards, sound barriers, anti-vandal and safety glazing.

### MAIN BENEFITS:

- High impact resistance - virtually unbreakable
- High clarity and light transmission
- Weather and UV resistant
- Wide service temperature range
- Blocks harmful UV radiation
- Good acoustical insulation
- Lightweight
- Easy to handle and install
- Versatile, formable and machinable

### TYPICAL APPLICATIONS:

- Skylights
- Architectural roofing
- Covered walkways
- Transparent acoustic barriers
- Light boxes and designed signage
- Shields and machine guards

### WORKS EXECUTED

- Hotel Mayura, Bengaluru - Area - 100 Sqm
  - PDS Residency, Krishnagiri - Area - 150 Sqm
  - Roof monitor at SVS warehouse, Bengaluru - Area - 1250 Sqm
  - Roof monitor at SSD-JV3, Bengaluru - Area - 1391 Sqm
  - Roof monitor at SSD-JV2, Bengaluru - Area - 853 Sqm
  - Roof monitor at RKV3, Bengaluru - Area - 1142 Sqm
  - Roof monitor at RKV4, Bengaluru - Area - 673 Sqm
- Many more works throughout India

Agrima brings out the lighting solutions into the buildings through skylights and poly carbonate roof covers from Palram, Israel. Our strength is our ability to develop innovative, high quality solutions adapting appropriate products. PALRAM with over 50 years of experience, a large portfolio of products and thousands of customers, is recognized as a leading brand for quality and service.





Green House at Mrs. Uma Iyengar Residence, Bengaluru



Green House at Mr. Desai's House, Bengaluru



Modular Carport at Mr. Sudhan's Residence, Thanjavur

### SYSTEM COMPONENTS:

- Clear Polycarbonate Panels
- Aluminum Frame
- Lockable door handle
- Easy assembly
- Built-In Gutters
- Roof vent
- Galvanized steel base

### MAIN BENEFITS:

- High impact resistance - virtually unbreakable
- 100% protection from harmful sun rays (UV)
- Controlled temperature & humidity
- Maintenance-free
- Higher Yield and Efficiency

### TYPICAL APPLICATIONS

- Commercial Growers
- Rooftop Greenhouse
- Proto-Greenhouse
- Extra room/space

### WORKS EXECUTED:

- Greenhouse (6'x6') at Dr. Desai's residence, Bangalore
- Greenhouse (6'x14') installed at Mr. George's residence, Bangalore and the crops grown inside the greenhouse
- Modular Gazebo(10'x14') at Mr. Subramani's residence, Bangalore
- Modular Carport(16'x10') at Mr. Sudhan's residence, Thanjavur

AGRIMA also promotes Terrace gardening in urban areas wherein we involve in provision of infrastructure for GREEN HOUSES and GARDEN GAZEBOS.

The Green Houses and Garden Gazebos which are made of PALRAM POLYCARBONATE are being used world wide since they are multi functional and efficient. The Polycarbonate used in these structures are virtually unbreakable, high-impact resistant and flexible and also can withstand extreme weather conditions for many years of use.

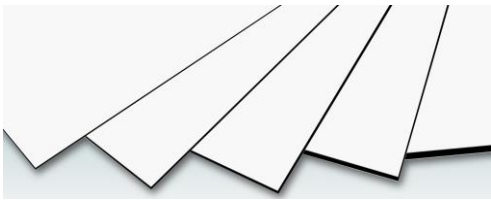

Palboard Sheet



Gokhale Institute of Public Affairs, Bengaluru



Print and Display application

**PALBOARD** is a hybrid version of solid PVC and foam PVC. This new breed of multi-layer PVC combines the extra-tough surface quality of solid PVC with the lightweight, easy-to-use characteristics of a foam PVC core made from recycled PVC.

## MAIN BENEFITS

- Hard, ultra-smooth surface with excellent ink adhesion
- Recycled lightweight foamed PVC core
- High structural strength with a relatively low weight
- Excellent chemical and fire resistance
- Easy to fabricate and thermoform
- Good adhesion capabilities
- Good electrical and thermal Insulation

## TYPICAL APPLICATIONS

- Digital and screen printing
- P-O-P displays
- Exhibits and kiosks
- Industrial and construction signs
- Fabricated and structural parts

## WORKS EXECUTED:

- Gokhale Institute of Public Affairs, , Bengaluru - Area - 282 Sqmtrs

PALBOARD is an innovative multilayered sheet that offers the qualities of rigid and foamed PVC together. Based on Palram's 50 year experience in extruding quality PVC sheets, it combines the surface quality and characteristics of rigid PVC with a reduced weight due to a recycled foamed PVC core.

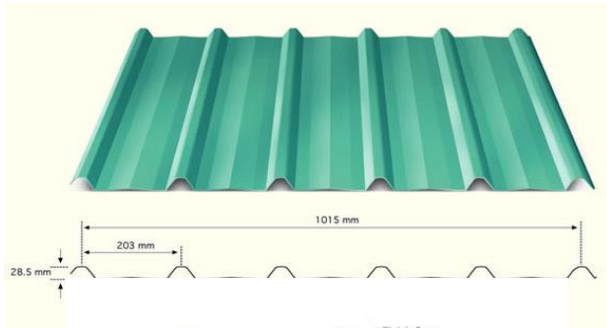

Sheet coating



Training Building, Jamshedpur



Canteen Building, Jamshedpur

**TRIMDEK** is modern ribbed roof and wall cladding profile with subtle fluting in the pans to provide strength and long spanning capabilities. It is ideal for industrial and commercial applications.

### BENEFITS

- Strong and wider coverage, makes it economical for all types of buildings
- Troughed valleys enhance easy water flow, roof traffic and to avoid oil canning
- Long roof runs at shallow roof slope (min 30°)
- Specially designed ribs, with unique anticapillary side lap, which makes it leak proof
- Curved roof: it is possible only in crimping option
- Easy to install on roof and wall cladding application

### WORKS EXECUTED

- LBSS Building, Jamshedpur Area – 700 Sqm
- Canteen Building, Jamshedpur Area – 400 Sqm
- Training Amenity Centre, Jamshedpur Area – 500 Sqm
- Two Wheeler Parking, Jamshedpur Area – 169 Sqm
- Car Parking, Jamshedpur Area – 300 Sqm
- Workers Lunch Room, Jamshedpur Area – 256 Sqm
- AB Bay Building, Jamshedpur Area – 5184 Sqm
- GH Low Bay Building, Jamshedpur Area – 4146 Sqm
- GH High Bay Building, Jamshedpur Area – 10,800 Sqm
- KL-LM-MN Bay Building, Jamshedpur Area – 3850 Sqm
- CD-DE-EF Bay Building, Jamshedpur Area – 22,500 Sqm and many more.

Agrima offers a wide range of premium roof and wall cladding profiles, structural products and accessories for the residential, industrial and commercial segments, being a part of LYSAGHT- TATA Blue scope steel ltd remarked as a trusted service provider.



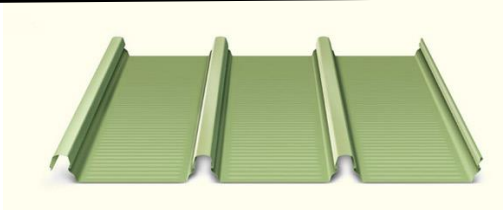

Klip-Lok Sheet



Klip-Lok Clip



Central workshop, Jamshedpur



**LYSAGHT KLIP-LOK®** has long been a design favourite, for prestigious commercial, industrial and architectural projects.

With a bold rib geometry rising from wide, flat pans, LYSAGHT KLIP-LOK® roof provides a strong visual statement on any building. Installed using a proprietary concealed fixing system there are no exposed fasteners to spoil the long, straight clean lines of LYSAGHT KLIP-LOK® roof.

### BENEFITS

- Strongest profile with longer spanning capability
- Fixed on specially designed clip which holds uplift pressure and also takes care of thermal expansion and contraction
- On site roll forming facility eliminates step joint and end laps.
- Specially designed ribs, with unique anti-capillary side lap, makes it leak proof roof slope of even up to 10 (1 in 50)
- Pre-crimping is possible to enable bull nose curve
- Economical and fast to install
- Manufactured from High Strength ZINCALUME® steel and or COLORBOND® steel

### WORKS EXECUTED

- Central Work Shop Building, Jamshedpur Area – 1728 Sqm
- Admin Building, Jamshedpur Area – 1123 Sqm
- Chemical Store, Jamshedpur Area – 650 Sqm
- Paint Store, Jamshedpur Area – 936 Sqm
- Workers Lunch Room, Jamshedpur Area – 234 Sqm



Agrima offers a wide range of premium roof and wall cladding profiles, structural products and accessories for the residential, industrial and commercial segments, being a part of LYSAGHT- TATA Blue scope steel ltd remarked as a trusted service provider.



### Flex-Lok System

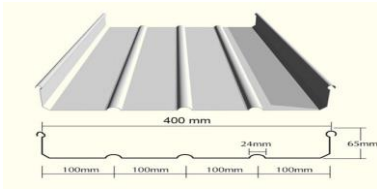

Flex-Lok Sheet



Flex-Lok Clip

**LYSAGHT FLEX-LOK®** concealed standing seam system is a roofing system with an innovative architectural appearance. It can be slope, curved or tapered to achieve various architectural requirements and provides architects with a more creative resource.

### BENEFITS

- Excellent weather and uplift resistance
- Heat insulated clip allows for movement, results from the thermal effect.
- Specially engineered thermal pad, reduce or eliminate thermal bridging effects.
- Can be roll-formed on site to achieve extreme long length according to project requirements
- It can be used as single skin roofing as well as double skin roofing.

### WORKS EXECUTED

- PEB Building for P & G, Hyderabad Area - 25000 Sqm



P & G Building, Hyderabad



Agrima offers a wide range of premium roof and wall cladding profiles, structural products and accessories for the residential, industrial and commercial segments, being a part of LYSAGHT- TATA Blue scope steel ltd remarked as a trusted service provider.

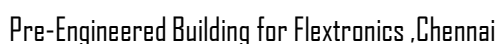
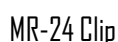
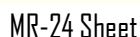

**MR-24®** roof system is one of the most time tested and widely used standing-seam roof system available. This record has been validated time and again by successful tests conducted in accordance with the most demanding & recognised specifications in the industry.

- MR-24® roof clip allows roof to expand and contract, ensuring free movement of the clip, assuring a long term leak proof performance
- Weather tight seams protect against leaks
- It is made from ZINCALUME® steel & COLORBOND® steel ensuring aesthetics with durability
- Slice support secures solid structures
- MR-24® have stronger fasteners that maintain credible strength
- Staggered panel splices prevent exposed seams
- MR-24® roof system's internal flange design conceals fasteners within the opening and eliminates leaks

- AB Bay Building, Jamshedpur Area – 5616 Sqm
- Flextronics, Chennai - Area – 25000 Sqm
- GH Low Bay Building, Jamshedpur Area – 2880 Sqm
- GH High Bay Building, Jamshedpur Area – 2880 Sqm
- L-LM-MN Bay Building, Jamshedpur Area – 1476 Sqm
- CD-DE-EF Bay Building, Jamshedpur Area – 25,704 Sqm



Agrima offers a wide range of premium roof and wall cladding profiles, structural products and accessories for the residential, industrial and commercial segments, being a part of LYSAGHT- TATA Blue scope steel ltd remarked as a trusted service provider.



## EXPORT PROJECT

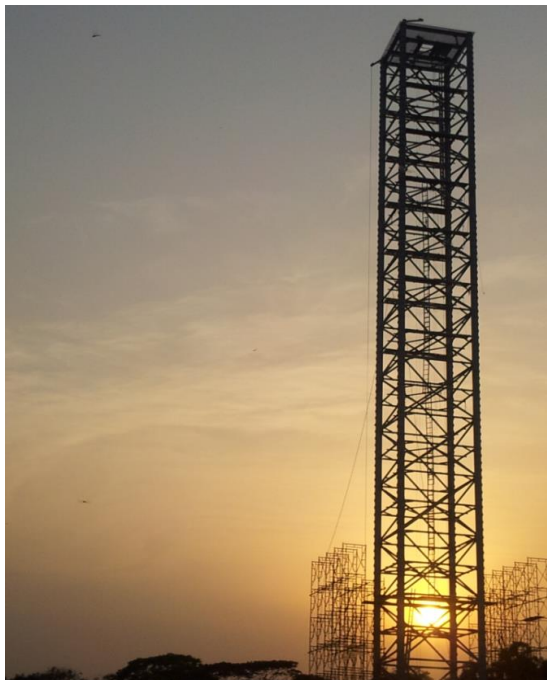

Freedom tower, Dhaka

## HEAVY STRUCTURAL STEEL WORKS



Coated steel plant, Jamshedpur



Concentrated Solar Power plant, Naukh, Rajasthan

